

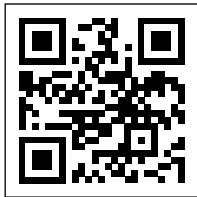

## CID1 Pre-Fabricated Modular Extraction Labs

# Double Wall Construction



Scan this code to  
visit our website



Made in the USA



- UL/ULc Certified (US & Canada)
- Insulated Double Wall Construction
- Smooth Inner/Outer Wall Construction
- “High-End” Showroom Finish
- Integrated Safety Features
- We Can Customize Anything
- Sizes Ranging From:  
8' wide x 8' deep x 8' tall  
up to  
24' wide x 80' deep x 16' tall

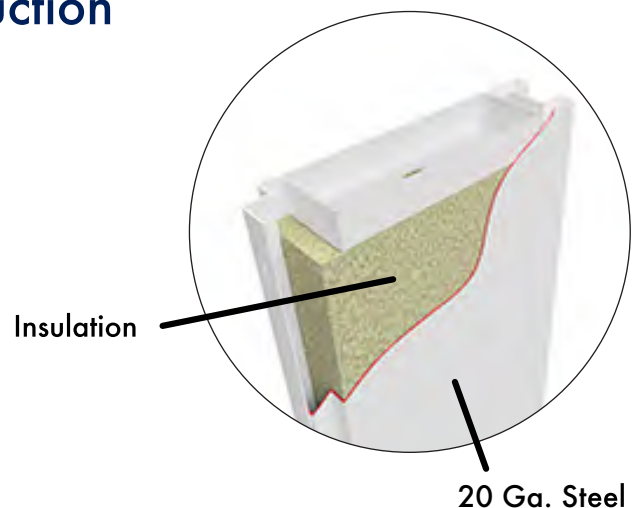



## CID1 Pre-Fabricated Modular Extraction Labs

**Eye Wash Kit**

**Interior CID1 Strobe & Alarm**

**Classified Lighting**

**System Status Strobe & Alarm**

**Hydraulic Door Latches**

**Exhaust Plenum**

**Gas Sensor**

**Hand Held Fire Extinguisher**

**Control Panel (System Controls)**

**Gas Sensor Display Unit**

- ← **Audible Alarm**  
Emits tone during 'Alarm 2' & 'Alarm 3' events.
- ← **Normal Operations**  
Green - On during normal operation.
- ← **Alarm 1**  
Blue - On during an 'Alarm 1' event.
- ← **Alarm 2**  
Amber - On during an 'Alarm 2' event.
- ← **Alarm 3 - Exhaust Fan Fault**  
Red - On during an 'Exhaust Fan Fault' event.

**OPERATIONAL CONTROLS**

- Exhaust Fans
- Lights
- Equipment Interlock

**SERVICE DISCONNECT**

**EMERGENCY PURGE**

**MANUAL HIGH VENTILATION MODE**

**podtronix**  
Engineered for Safety • Designed for Success

Our CID1 Extraction Labs are engineered to fit your facility's environment perfectly.

The following components and features are all UL/ULc certified and designed to work seamlessly with our fully automated controls, providing you with the highest levels of performance and safety:

- Automatic Safety Control Panel
- Integrated Gas Detection System
- Visual and Audio Alarms
- Self Closing, Self Sealing Doors
- Bright and Highly Efficient LED Lighting
- Optimized Airflow Design with Dual Speed for Added Safety
- Minimal Full Load Amp Draw





## Ask Us About Facility Build-Outs

